

**DIPLOMA EXAMINATION IN ENGINEERING/TECHNOLOGY/
MANAGEMENT/COMMERCIAL PRACTICE — OCTOBER, 2018**

BUILDING PLANNING AND DRAWING

[Time : 3 hours

(Maximum marks : 100)

- [Note :—1. Question No. II is compulsory.
2. Missing data may be suitably assumed.
3. Drawing shall be neat and fully dimensioned.
4. A2 size drawing sheet to be supplied.
5. Sketches on 4th Page.]

PART — A

(Maximum marks : 15)

Marks

I Answer *all* questions in one or two sentences. Each question carries 1½ marks.

1. Define FAR.
2. Give the names of any three sanitary fittings.
3. What are the different types of culvert ?
4. Enumerate the circumstances for providing a combined footing.
5. Give the conventional signs for Indian type water closet, kitchen sink and bath tub.
6. Define plinth area.
7. What is a Mezzanine floor ?
8. Differentiate between clear span and effective span.
9. What do you mean by the frontage of a building ?
10. What is the minimum area of a kitchen as per NBC ?

(10 × 1½ = 15)

PART — B

(Maximum marks : 85)

- II (a) Prepare the line plan for a residential building to suit for a plot of 26m × 24m size, according to NBC and KMBR requirements. A road of 5m width abuts the 26m side. The total built up area of the building should not to exceed 200m². It should satisfy the following requirements.
- Sit out
 - Car porch
 - 2 nos. bed rooms with attached bath
 - Dining and drawing
 - Kitchen and work area

25

- (b) Prepare a detailed plan and section along XX in 1:100 scale for the line sketch of the residential building given in figure (i).

PCC for foundation, 1:4:8 - 80cm × 20cm

RR masonry for foundation in CM 1:8 - 60cm × 60cm

RR masonry for basement in CM 1:8 - 45cm × 45cm

Superstructure, 20cm thick brick wall in CM 1:6, 3m high. (Provide lintel height for sit out & car porch)

Roofing, RCC slab, M20 grade, 10cm thick with 10cm projection.

Parapet wall, 10cm thick brick wall in CM 1:6, 60cm height, provided throughout. (Provide 20cm height over sit out and car porch)

Sun shade, RCC, 7.5cm thick, 40cm wide, provided through out.

Lintel, RCC, 15cm thick, provided through out.

Steps, rise-15cm, tread 27cm.

Hand rails for sit out in cast iron, 60cm height.

Doors : D-110cm×200cm, D1-100cm × 200cm, D2-95cm × 200cm

Windows: W-200cm × 150cm, W1-150cm × 150cm, W2-100cm × 150cm

Ventilators: V-75cm × 45cm

Provide pillars and flooring suitably.

(Assume any other data necessary)

(15+15)

- III Draw the foundation details for steps and wall Given,

Brick wall, 20cm thick in CM 1:4

Basement in RR masonry, CM 1:4 - 40cm × 60cm

Foundation in RR masonry, CM 1:4 - 50cm × 60cm

PCC, 1:4:8 - 80cm × 20cm

Steps in brick masonry: rise-15cm, tread-30cm, PCC-10cm thick

Floor concrete, 10cm thick, Floor finish 2cm thick

15

OR

IV Draw the plan and sectional elevation to a suitable scale of a dog legged RCC stair in a $5\text{m} \times 2\text{m}$ room having the following details :

First flight - 12nos. steps

Second flight - 4nos. steps

Rise - 17cm

Tread - 25cm

Thickness of waist slab - 21cm

Thickness of landing slab - 10cm

Width of landing slab - 100cm

Reinforcement details : - main bar $12\text{mm}\phi$, $10\text{mm}\phi$ distributors @ $125\text{mm}/\text{c}$.

Assume all other data necessary.

15

V Draw the longitudinal section of a slab culvert in a suitable scale having the following details :

RL at top of culvert slab 99.000m

RL at base of foundation 92.350m

Clear span - 4m

Road width - 7m

Slab thickness - 30cm

Abutment foundation - $180\text{cm} \times 40\text{cm}$

Abutment width - 60cm throughout the height

The returns are square, projecting 1.2m from earth face of abutment.

Provide parapet and kerb suitably.

15

OR

VI Prepare a plumbing layout of fig (ii) showing the water supply and sanitary fixtures.



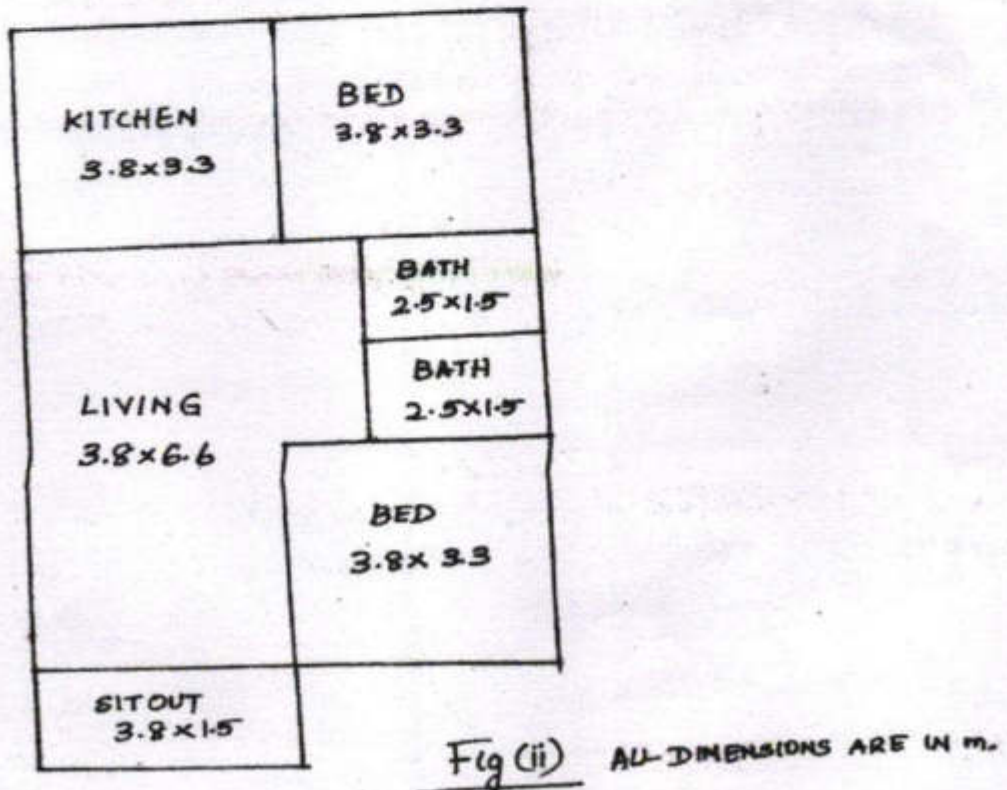
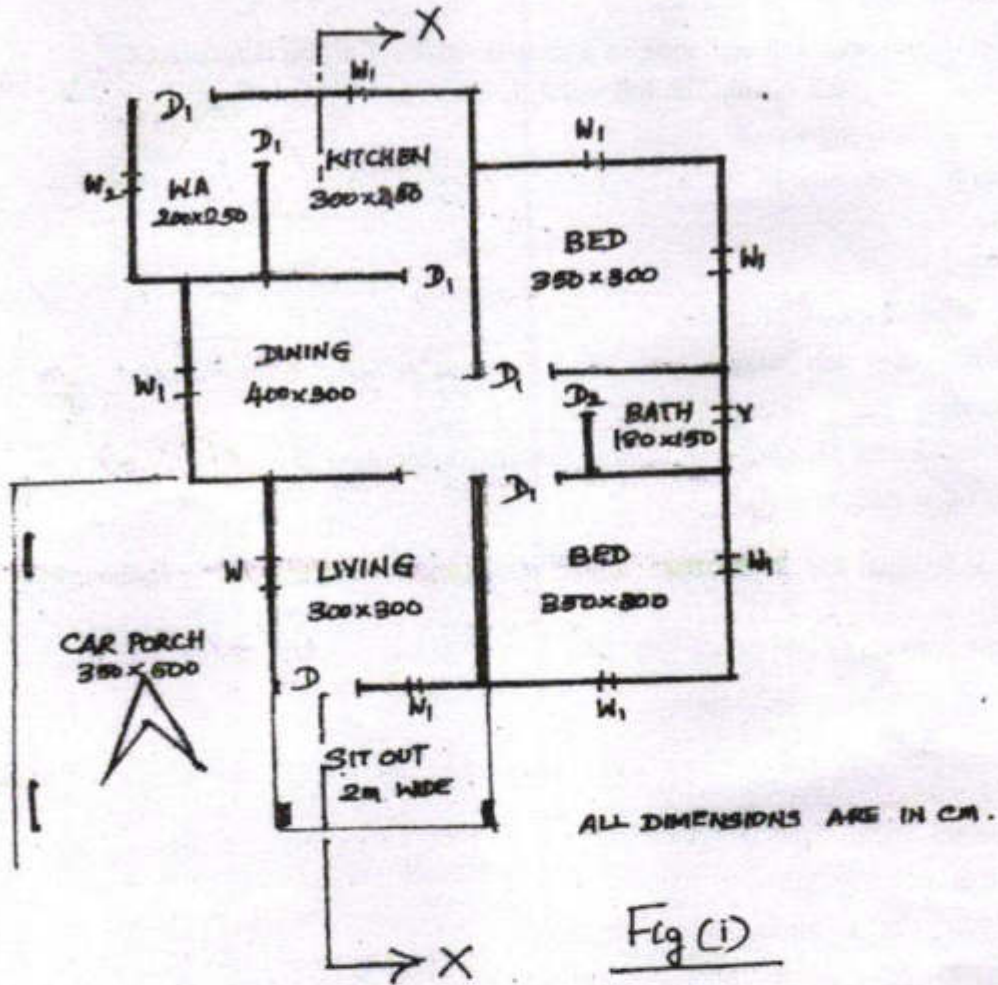

15



8

THIRD SEMESTER DIPLOMA EXAMINATION IN
ENGINEERING TECHNOLOGY
BUILDING PLANNING AND DRAWING

Time: 3 Hours

Question No:	Answers	Split score	Total score
1.	<p>1. FAR-floor area ratio is the quotient obtained by dividing the total covered area (plinth area) on all the floors by the area of the plot.</p> <p>2. Shower, wash basin, water closet, bath tub, tap etc.</p> <p>3. Slab culvert, box culvert, pipe culvert, arch culvert etc.</p> <p>4. It is used when the two columns are so close to each other that their individual footings would overlap. A combined footing is also provided when the property line is so close to one column that a spread footing would be eccentrically loaded when kept entirely within the property line.</p> <p>5. Indian type water closet-  Kitchen sink-  Bath tub- </p> <p>6. Plinth area:- is the built up covered area measured at the floor level of the basement or of any storey.</p> <p>7. Mezzanine floor:- an intermediate floor in any storey overhanging and overlooking a floor beneath.</p> <p>8. Clear span:-  Effective span:-  The centre to centre distance between two supports is called effective span. The distance between two supports is called clear span.</p> <p>9. Frontage- side or part of a side of a plot, which abuts on a street.</p> <p>10. Minimum area of kitchen as per NBC:-5.5 sqm</p>	11/2 x 10	

PART-B

Ques: No: II (a)

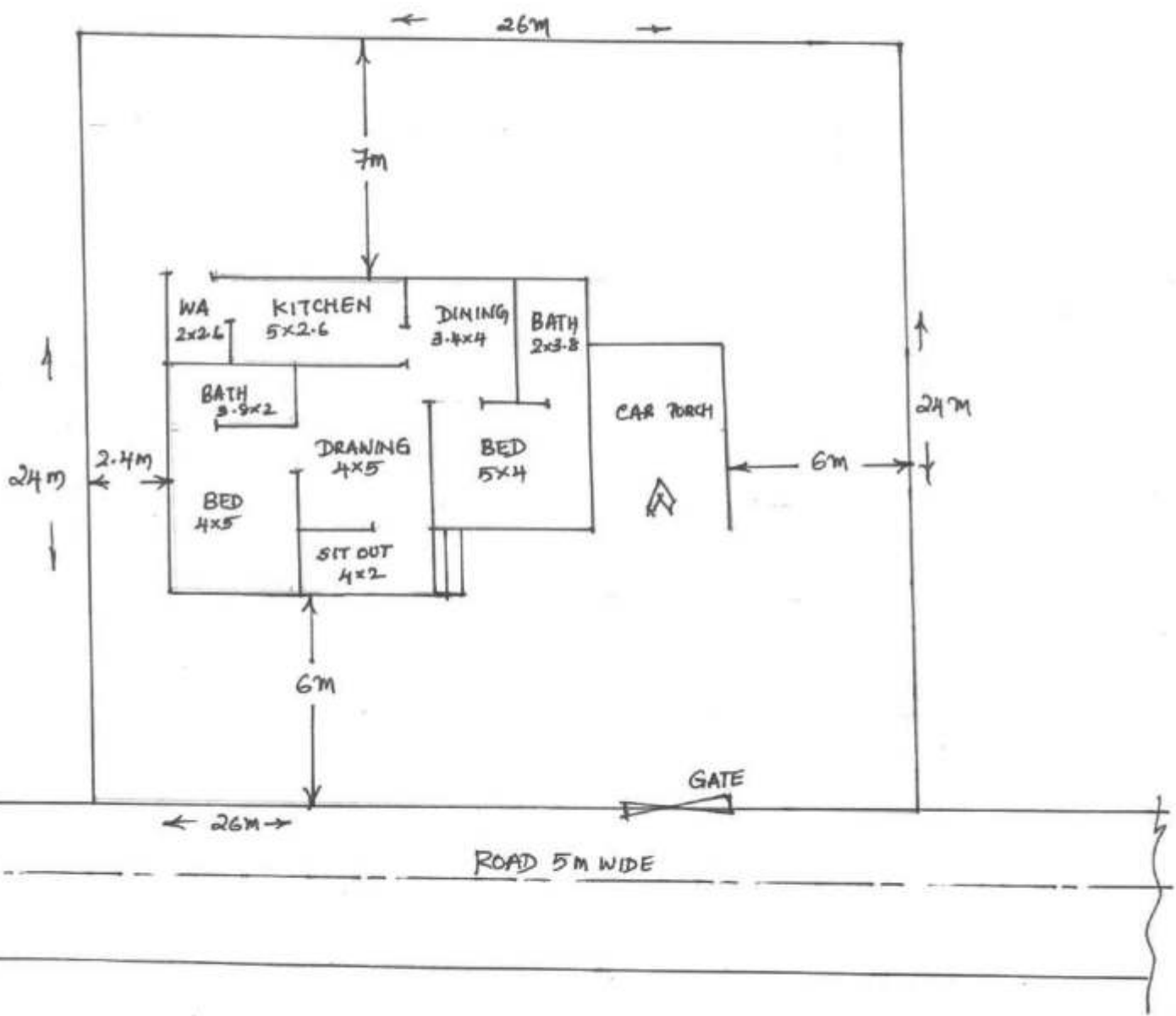

25 marks

PART- B

Ques: II (b)

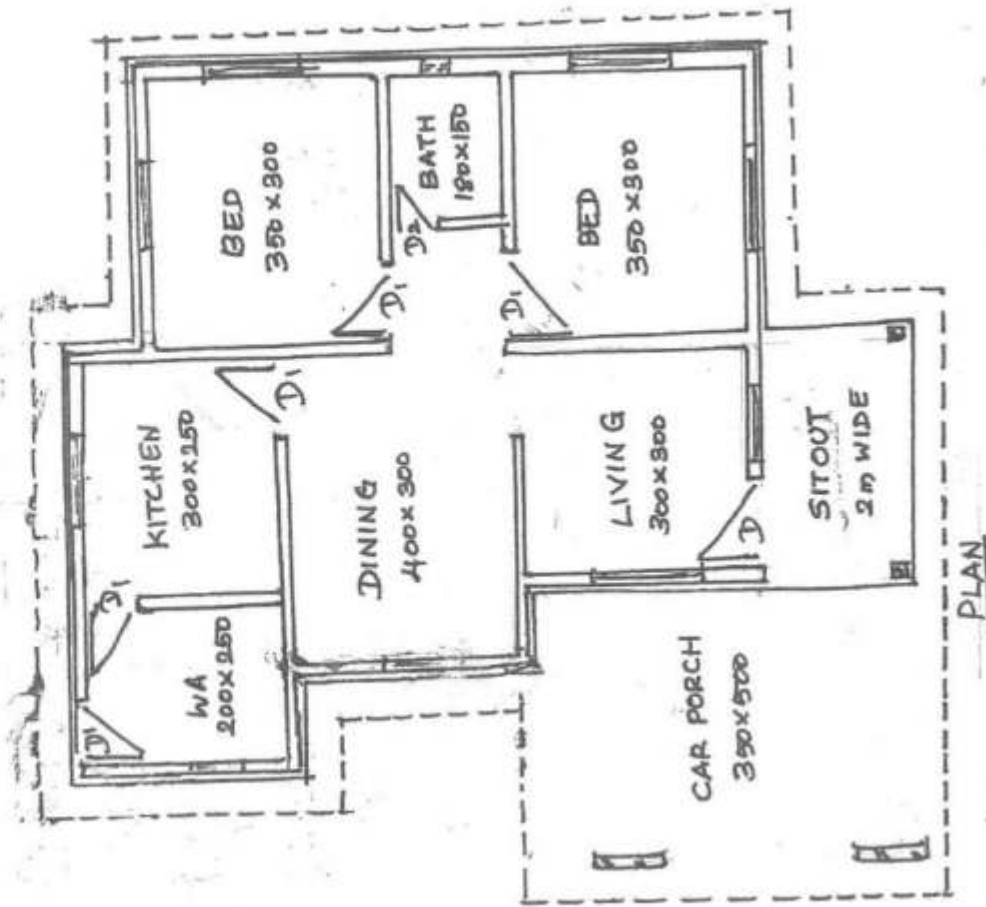

Fig-10
Naming &
Dimensioning } -5

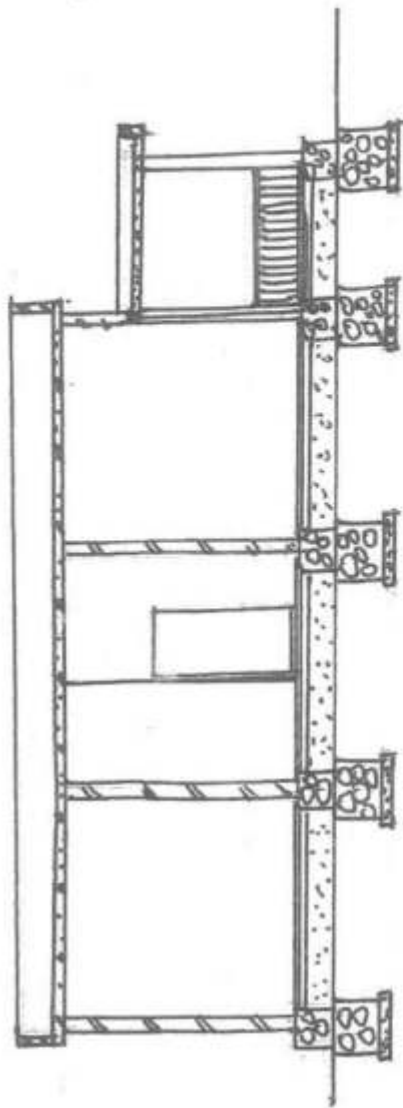
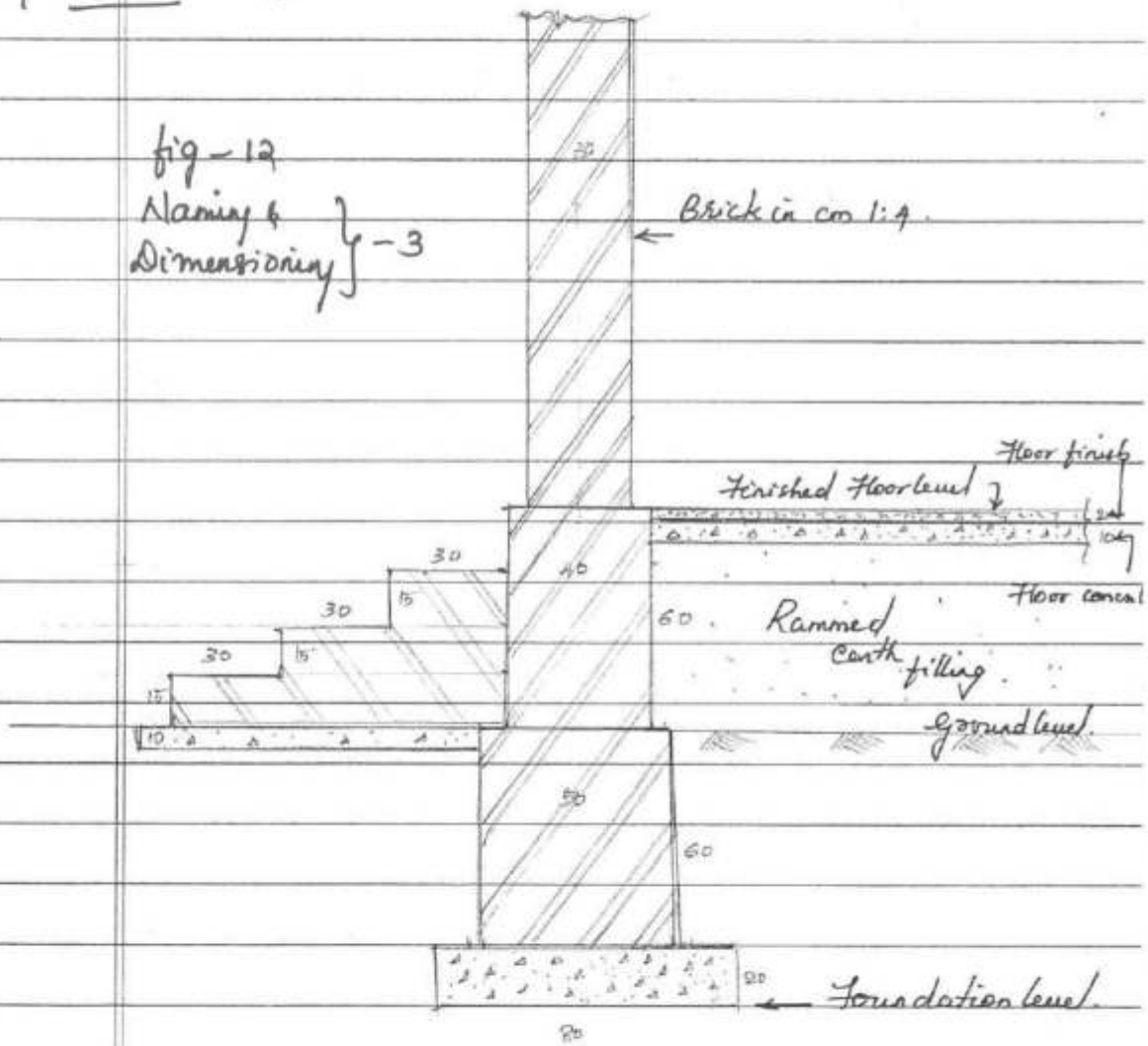

Fig-12
Naming &
Dimensioning } -3

Different levels in foundation -
 Foundation details for steps & wall -

Question no: III

fig - 12
 Naming &
 Dimensioning } -3



Ques: no: IV

Fig - 15

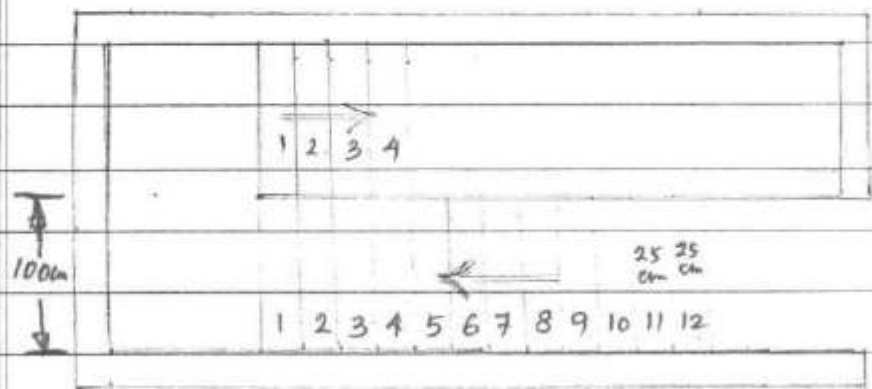
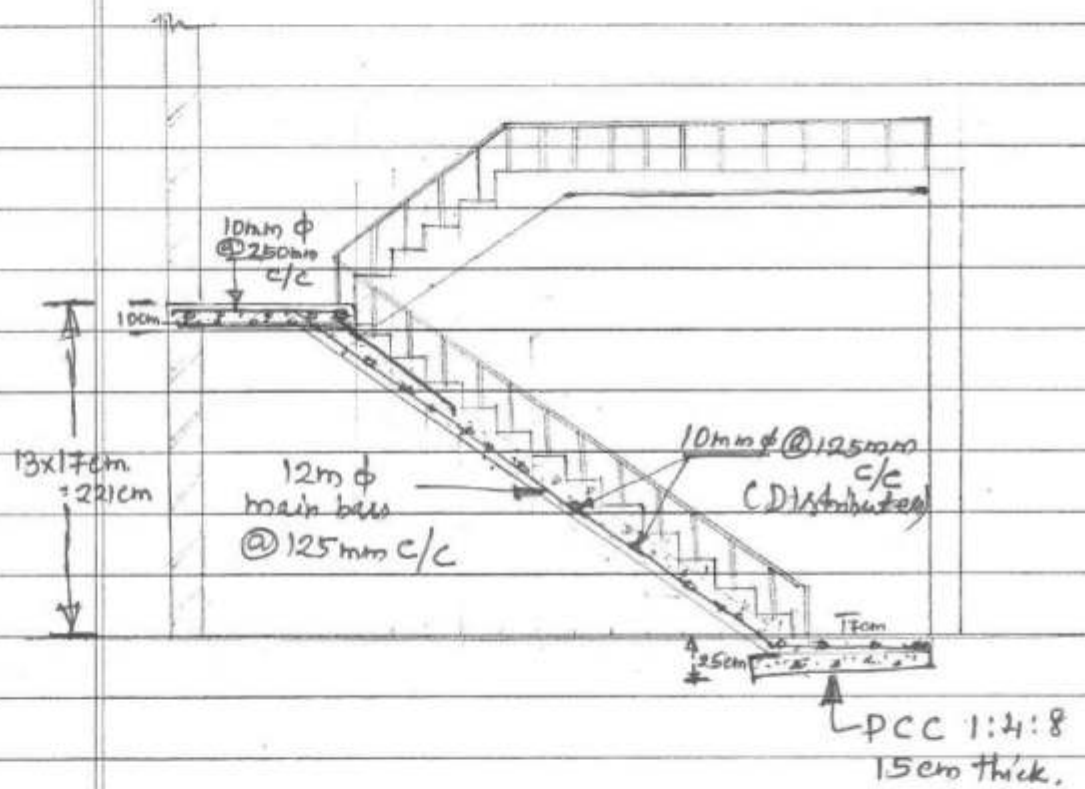

PLAN.

Ques: No: V

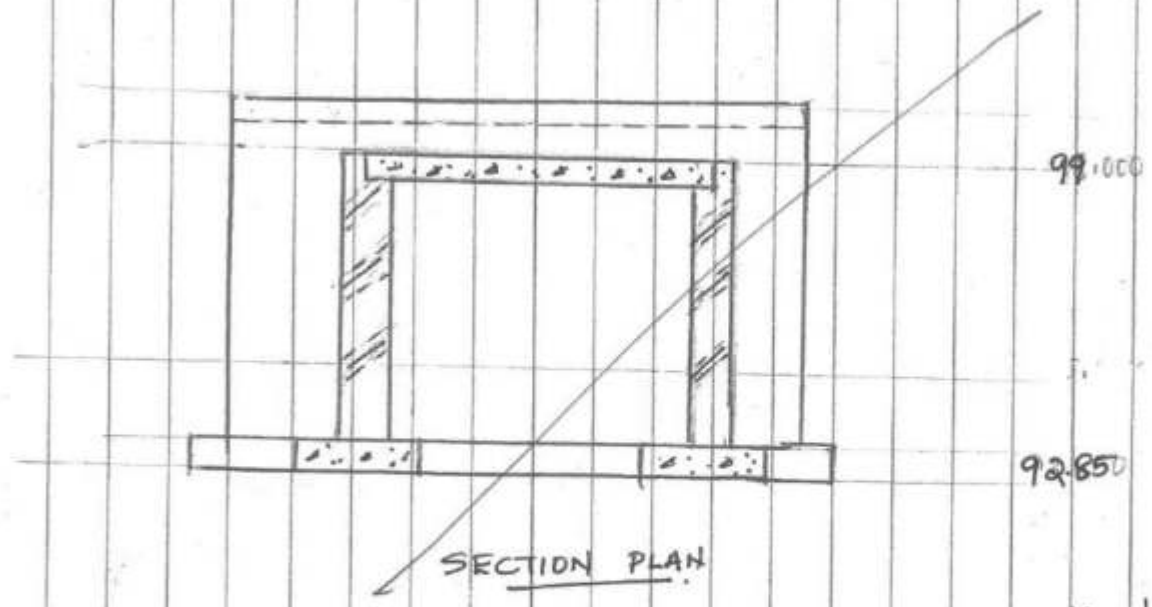

15 Marks

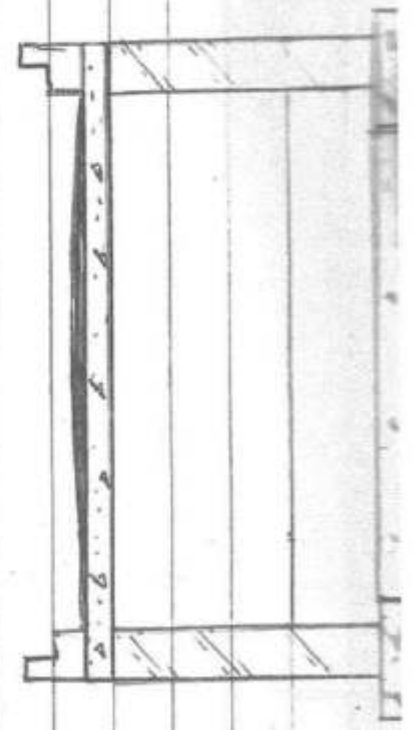
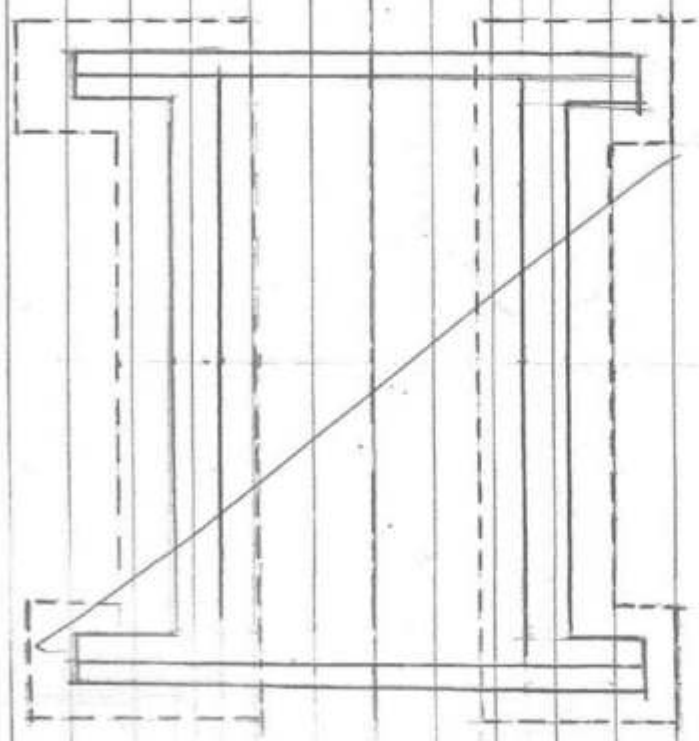

Ques: No: VI

7

15 Marks

- GT - Gully trap
- MH - Man Hole
- MVP - Main vent pipe
- SP - Soil pipe
- Sh - Shower
- WB - Wash Basin
- S - Sink
- WC - Water closet
- RWP - Rain water pipe
- IC - Interrupting chamber

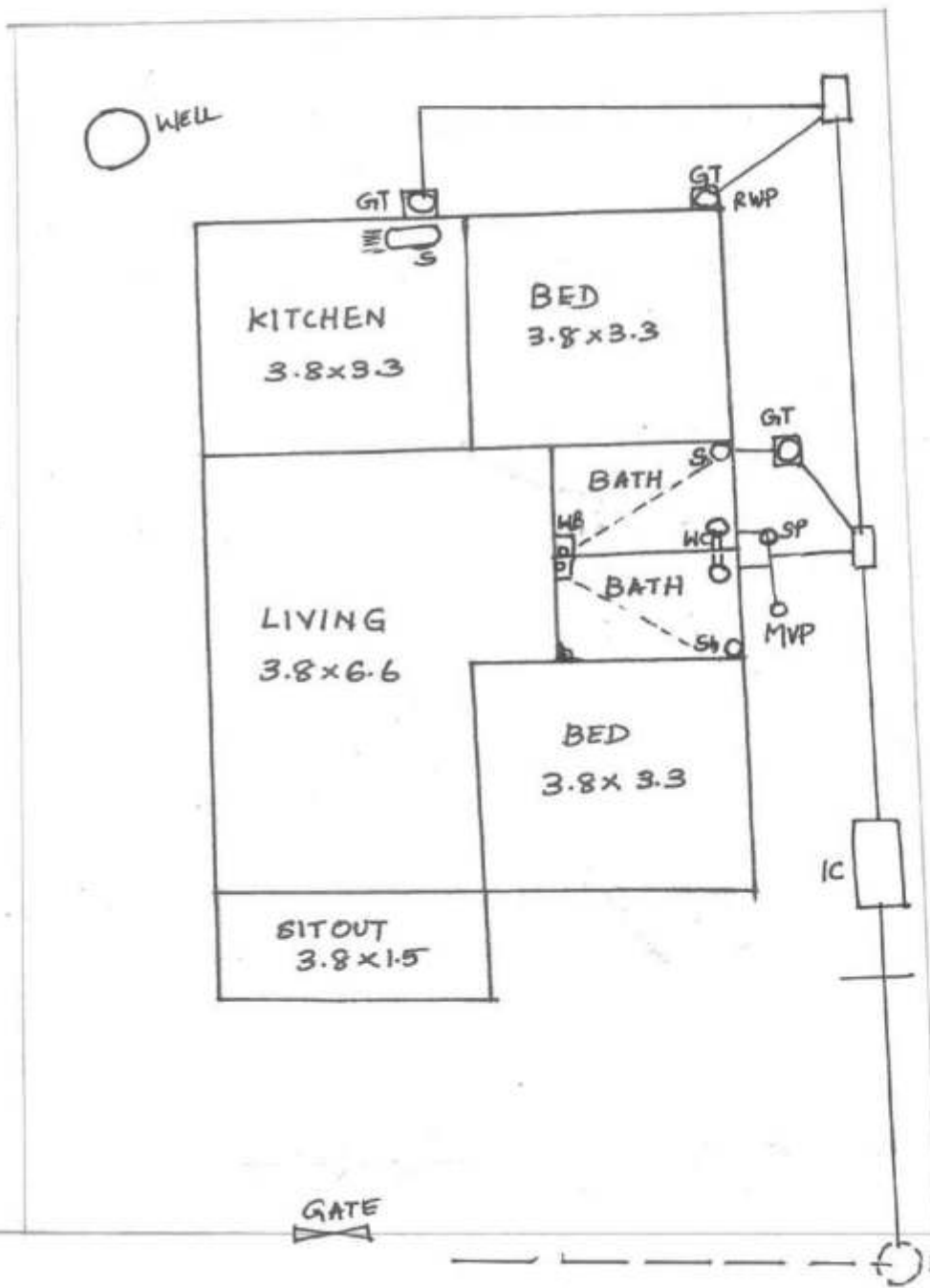

15 Marks

OR provide Septic tank & Soak pit

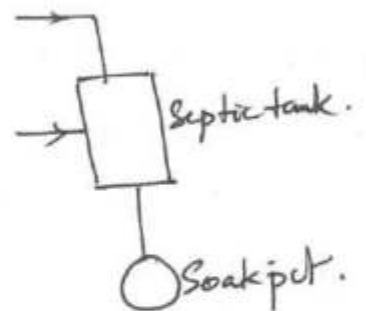



GOVT. OF KERALA
DEPARTMENT OF TECHNICAL EDUCATION
OFFICE OF THE CONTROLLER OF TECHNICAL EXAMINATIONS
THIRUVANANTHAPURAM

DIPLOMA EXAMINATION IN ENGINEERING / TECHNOLOGY / MANAGEMENT

CORRECTION NOTE

(Answer)

Answer to question No. 5 (Longitudinal Section of Slab Culvert) is not correct and incomplete. (PART-B)